

**turning spindle:  
A6 (DIN 55026)**

**620 min<sup>-1</sup>**

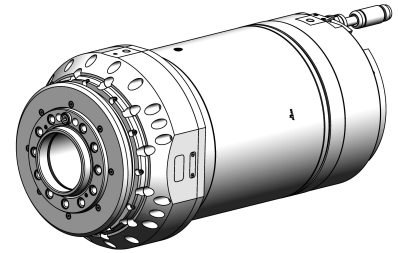

**specification**

12.9.2017

interface:	A6 (DIN 55026)
cleaning air:	
tool release unit:	
rotation unit:	
encoder:	Heidenhain ERM/ERA
increment number:	14000
max. speed:	620 min <sup>-1</sup>
nominal speed:	430 min <sup>-1</sup>
nominal power:	7 kW
nominal torque:	155,5 Nm
kind of motor:	synchronous
moment of inertia (spindle):	0,3200 kgm <sup>2</sup>
spindle housing design:	quill
installation diameter:	300 mm
total length:	640 mm
working position:	horizontal
front bearing:	
ISO Size Code:	10
bearing bore diameter:	140 mm
bearing pitch circle diameter:	175 mm
character speed value:	0,11 Mio dn
rear bearing:	
ISO Size Code:	10
bearing bore diameter:	100 mm
Arrangement of bearings:	=<> M =
bearing Lubrication:	grease

