

**milling spindle:
SK 40 BIG-Plus**

15.000 min⁻¹

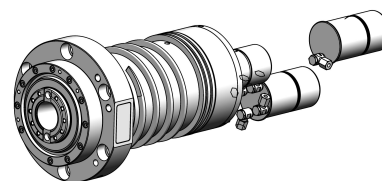

specification

1.2.2021

interface:	SK 40 BIG-Plus
tool release unit:	none
rotation unit:	no
encoder:	no
max. speed:	15000 min ⁻¹
nominal speed:	0 min ⁻¹
nominal power:	0 kW
nominal torque:	0,0 Nm
kind of motor:	synchronous
spindle housing design:	quill
installation diameter:	160 mm
total length:	461 mm
working position:	horizontal/vertical
bearing Lubrication:	re-greasing

WEISS
G M B H