

**milling spindle:  
BT 40 (45°)**

**15.000 min<sup>-1</sup>**

**specification**

1.2.2021

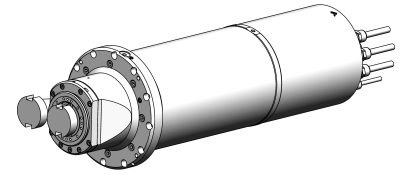

|                         |                         |
|-------------------------|-------------------------|
| interface:              | BT 40 (45°)             |
| tool release unit:      | hydraulic               |
| rotation unit:          | yes                     |
| encoder:                | yes                     |
| max. speed:             | 15000 min <sup>-1</sup> |
| nominal speed:          | 3000 min <sup>-1</sup>  |
| nominal power:          | 26,4 kW                 |
| nominal torque:         | 84,0 Nm                 |
| kind of motor:          | synchronous             |
| spindle housing design: | quill                   |
| installation diameter:  | 200 mm                  |
| total length:           | 807 mm                  |
| working position:       | vertical/nose down      |
| bearing Lubrication:    | grease                  |