

**grinding spindle:
special**

18.000 min⁻¹

specification

1.2.2021

interface:	special
tool release unit:	none
rotation unit:	no
encoder:	no
max. speed:	18000 min ⁻¹
nominal speed:	8000 min ⁻¹
nominal power:	23 kW
nominal torque:	27,5 Nm
kind of motor:	asynchronous
spindle housing design:	quill
installation diameter:	170 mm
total length:	464 mm
working position:	horizontal
bearing Lubrication:	oil air

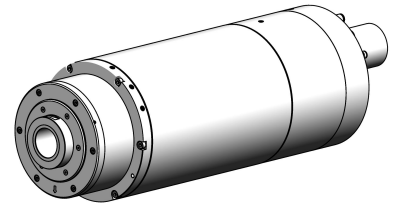

WEISS
G M B H