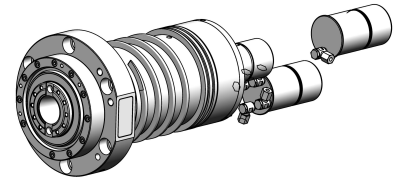

**milling spindle:
SK 40 BIG-Plus****15.000 min⁻¹****specification**

18.11.2020

interface:	SK 40 BIG-Plus
cleaning air:	none
tool release unit:	none
rotation unit:	none
encoder:	none
increment number:	
max. speed:	15000 min ⁻¹
nominal speed:	0 min ⁻¹
nominal power:	0 kW
nominal torque:	0,0 Nm
kind of motor:	none
moment of inertia (spindle):	0,0000 kgm ²
spindle housing design:	quill
installation diameter:	160 mm
total length:	461 mm
working position:	horizontal/vertical
front bearing:	
ISO Size Code:	10
bearing bore diameter:	70 mm
bearing pitch circle diameter:	90 mm
character speed value:	1,35 Mio dn
rear bearing:	
ISO Size Code:	10
bearing bore diameter:	65 mm
Arrangement of bearings:	<<~>> =
bearing Lubrication:	re-greasing