

**milling spindle:  
BT 40 (45°)****15.000 min<sup>-1</sup>****specification**

14.1.2021

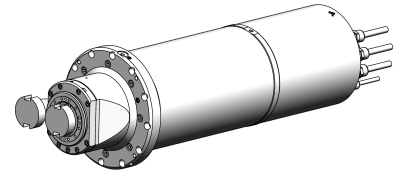

interface:	BT 40 (45°)
cleaning air:	1 channel
tool release unit:	WEISS/Hydr.
rotation unit:	OTT
encoder:	VS Sensorik
increment number:	256
max. speed:	15000 min <sup>-1</sup>
nominal speed:	3000 min <sup>-1</sup>
nominal power:	26,4 kW
nominal torque:	84,0 Nm
kind of motor:	synchronous
moment of inertia (spindle):	0,0240 kgm <sup>2</sup>
spindle housing design:	quill
installation diameter:	200 mm
total length:	807 mm
working position:	vertical/nose down
front bearing:	
ISO Size Code:	19
bearing bore diameter:	70 mm
bearing pitch circle diameter:	85 mm
character speed value:	1,27 Mio dn
rear bearing:	
ISO Size Code:	10
bearing bore diameter:	60 mm
Arrangement of bearings:	<<~> M ~>>
bearing Lubrication:	grease

**WEISS**  
G M B H