

**grinding spindle:
special**

33.000 min⁻¹

specification

13.1.2017

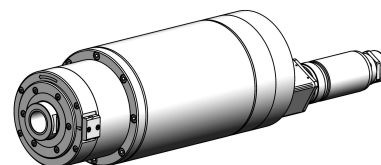

interface:	special
tool release unit:	none
rotation unit:	no
encoder:	no
max. speed:	33000 min ⁻¹
nominal speed:	23735 min ⁻¹
nominal power:	18 kW
nominal torque:	7,2 Nm
kind of motor:	asynchronous
spindle housing design:	quill
installation diameter:	150 mm
total length:	388 mm
working position:	horizontal
bearing Lubrication:	oil air

WEISS
G M B H