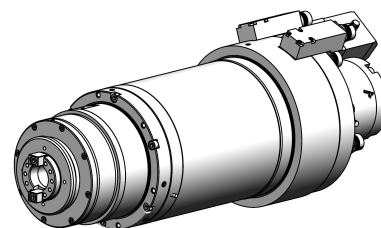

**grinding spindle:
SK 30****15.000 min⁻¹****specification**

13.1.2017

interface:	SK 30
tool release unit:	hydraulic
rotation unit:	no
encoder:	yes
max. speed:	15000 min ⁻¹
nominal speed:	10000 min ⁻¹
nominal power:	31 kW
nominal torque:	29,6 Nm
kind of motor:	synchronous
spindle housing design:	quill
installation diameter:	171 mm
total length:	551,5 mm
working position:	tilting
bearing Lubrication:	re-greasing